

ME778-	X		
	↑	INLET PORT	#26 STEEL ELBOW
4		1/2" FNPT	ME777-125
6		3/4" FNPT	ME777-126

#	QTY	DESCRIPTION	MATERIAL
1	1	BODY	12L14 STEEL
2	1	O-RING, #2-112	HYDROGENATED NITRILE
3	1	STEM GLAND	300 SERIES STAINLESS
4	1	O-RING, #2-109	HYDROGENATED NITRILE
5	1	O-RING, #2-115	HYDROGENATED NITRILE
6	1	SEAL RETAINER	316 STAINLESS
7	1	STEM SEAL	HYDROGENATED NITRILE
8	1	STEM GUIDE	ALUMINUM A380-T5
9	1	STEM	303 STAINLESS STEEL
10	1	LOCKING SET SCREW	STAINLESS STEEL
11	1	QC POL NIPPLE	SEE NOTE
12	1	POL BEARING	302 STAINLESS STEEL
13	1	QCC NUT	SEE NOTE
14	1	BUSHING	6/6 NYLON
15	1	SET SCREW	STAINLESS STEEL
16	1	UPPER STEM	303 STAINLESS STEEL
17	1	STEM RETAINER	4130 STEEL
18	1	SPRING RETAINER	12L14 STEEL
19	1	CLOSING SPRING	17-7 STAINLESS STEEL
20	1	BONNET	6/6 NYLON
21	1	45° NPT STEEL ELBOW	STEEL
22	1	HANDLE	6061-T6 ALUMINUM
23	1	LATCH	300 SERIES STAINLESS
24	1	SPRING	17-7 STAINLESS STEEL
25	2	GROOVED DOWEL PIN	ZINC PLATED STEEL
26	2	COVER SCREW	STAINLESS STEEL
27	1	HOOK	300 SERIES STAINLESS

THIS DOCUMENT IS THE PROPERTY OF MARSHALL EXCELSIOR CO. AND CONTAINS PROPRIETARY AND CONFIDENTIAL INFORMATION WHICH MAY NOT BE DUPLICATED, USED, OR DISCLOSED OTHER THAN AS EXPRESSLY AUTHORIZED BY MARSHALL EXCELSIOR CO.

**Marshall Excelsior Company,**  
Marshall Michigan 49068

DESCRIPTION:  
ASSEMBLY  
LE POL FILLER VALVE TYPE I

SHT: 1 of 2 PART NO: ME778-X

**A**

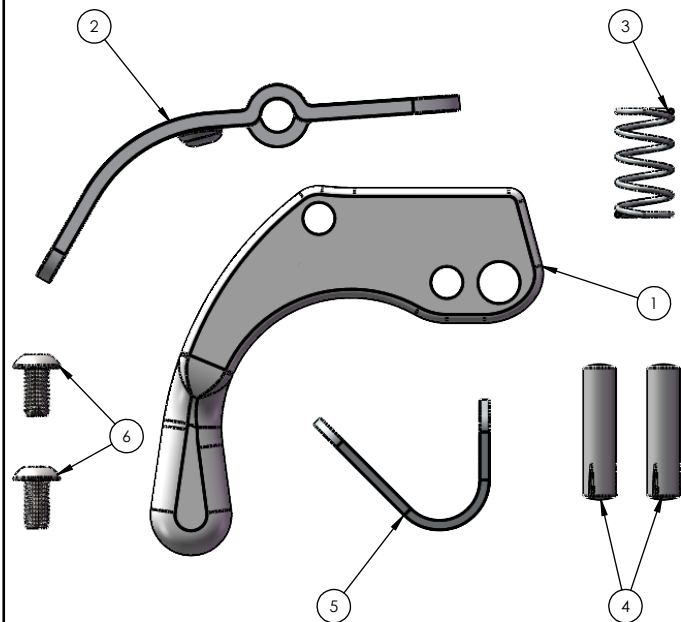

## ME777-HRK

#	QTY	DESCRIPTION	MATERIAL
1	1	HANDLE	6061-T6 ALUMINUM
2	1	LATCH	300 SERIES STAINLESS
3	1	SPRING	17-7 STAINLESS
4	2	GROOVED DOWEL PIN	ZINC PLATED STEEL
5	1	HOOK	300 SERIES STAINLESS
6	2	COVER SCREW	STAINLESS STEEL

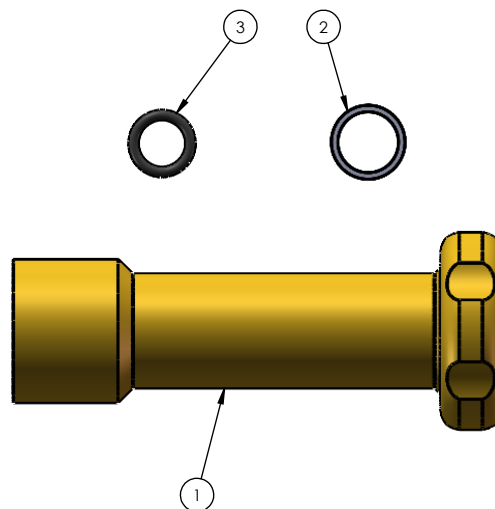

## ME778-CRK

#	QTY	DESCRIPTION	MATERIAL
1	1	QCC NUT	CA360 BRASS
2	1	POL BEARING	302 STAINLESS STEEL
3	1	O-RING, #2-112	HYDROGENATED NITRILE

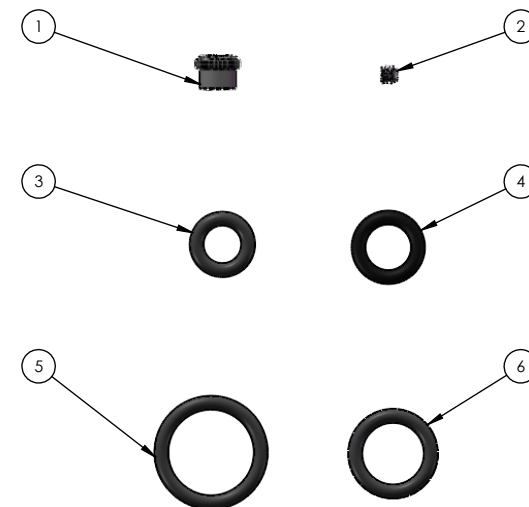

## ME777-SRK

#	QTY	DESCRIPTION	MATERIAL
1	1	STEM SEAL	HYDROGENATED NITRILE
2	1	LOCKING SET SCREW	STAINLESS STEEL
3	1	O-RING, #2-109	HYDROGENATED NITRILE
4	1	O-RING, #2-110	HYDROGENATED NITRILE
5	1	O-RING, #2-115	HYDROGENATED NITRILE
6	1	O-RING, #2-112	HYDROGENATED NITRILE

THIS DOCUMENT IS THE PROPERTY OF MARSHALL EXCELSIOR CO. AND CONTAINS PROPRIETARY AND CONFIDENTIAL INFORMATION WHICH MAY NOT BE DUPLICATED, USED, OR DISCLOSED OTHER THAN AS EXPRESSLY AUTHORIZED BY MARSHALL EXCELSIOR CO.

**Marshall Excelsior Company,**  
Marshall Michigan 49068

DESCRIPTION:  
REPAIR KITS

SHT: 2 of 2 PART NO:

**A**